

19.36 Acres Pre Developed and Ready to Break Ground Sabal Ridge - Tampa, Florida (Multifamily or Office Park)

Presented by

**BRODERICK & ASSOCIATES
INC.**

A Licensed Florida Real Estate Broker
General Contractor and Commercial Property Investments



Prepared by Robert Barber



19.36 Acres – Sabal Ridge



- Hillsborough County
- Property is situated at the corner of East Dr. MLK and Clewis Ave
- Access to main roads both East/West and North/South and Interstate system
- Zoned PD with Land Use CMU-12

19.36 Acres – Sabal Ridge



Overview of Area



19.36 Acres – Sabal Ridge



Hillsborough County Traffic Data 2001

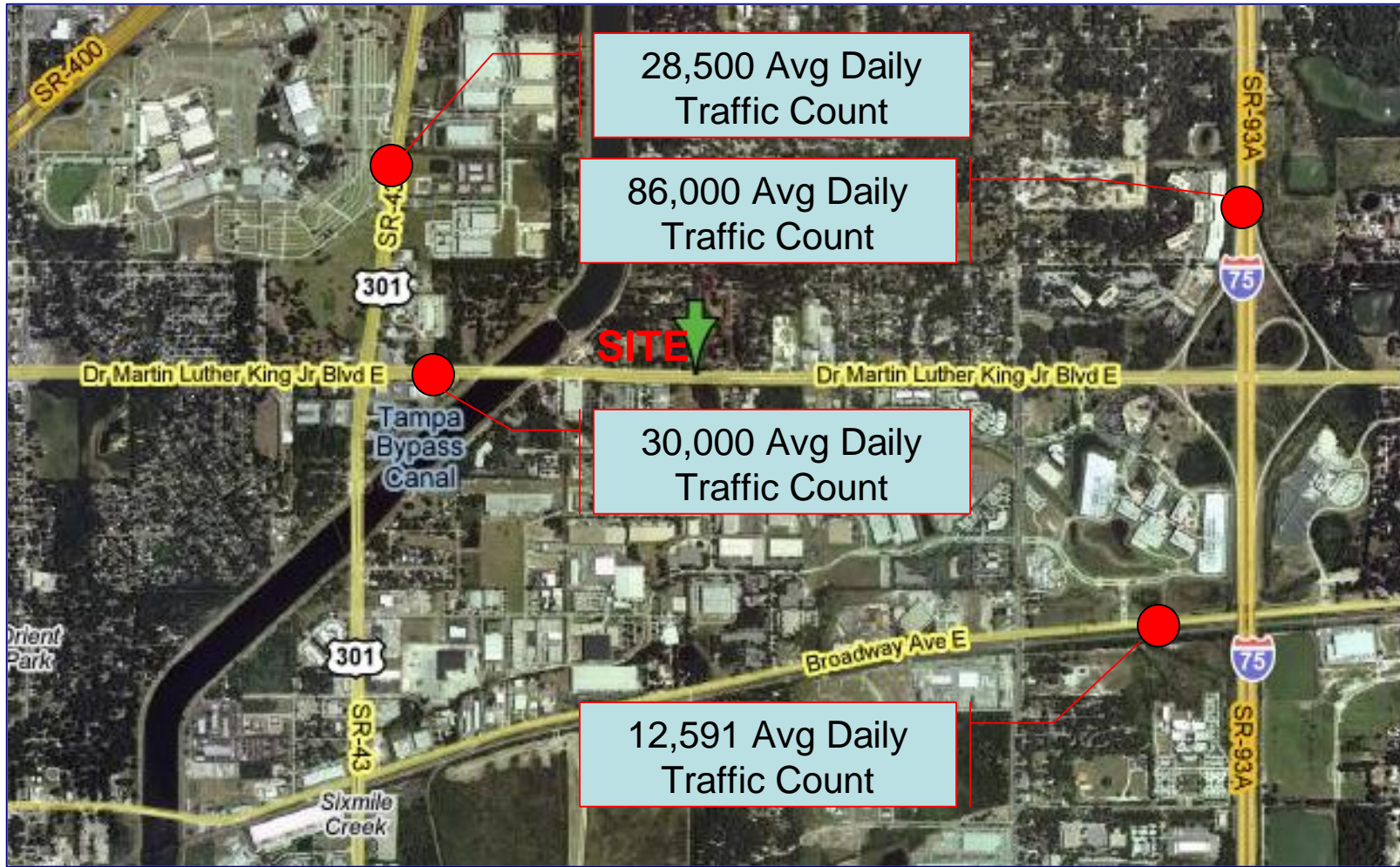

19.36 Acres – Sabal Ridge

Property Aerial (Shaded Area is an Estimation)



19.36 Acres – Sabal Ridge

Approved Site Plan Includes 182 Multifamily Units

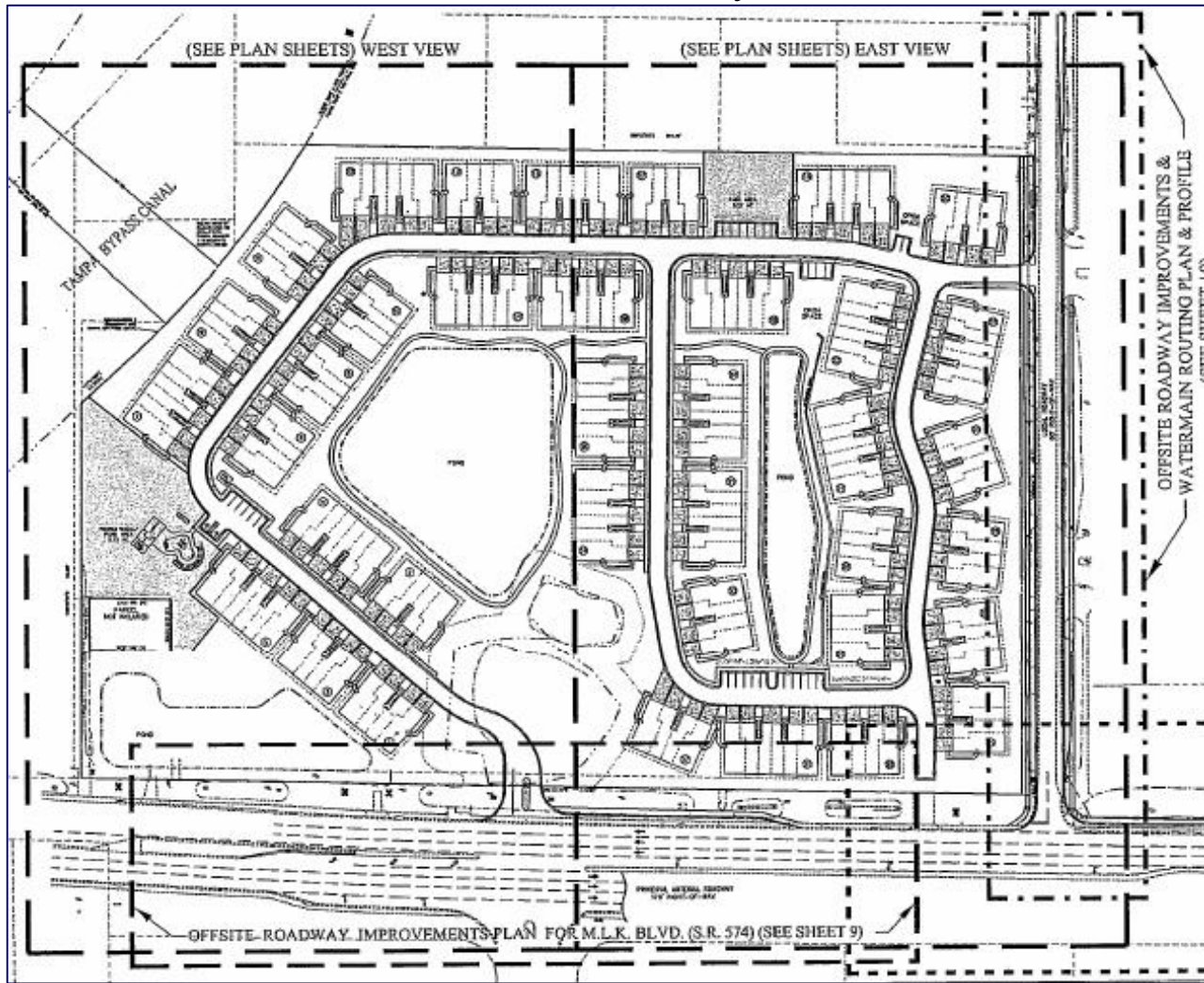

19.36 Acres – Sabal Ridge



Price \$7,500,000.00
Contact Roger Broderick or Robert Barber

Broderick and Associates
5514 Park Blvd, FL 33781
727-544-1403